



EN 1825-1

Greaser™

Engineered Grease Separators

The **Greaser™** Food Wastewater Grease Separator is a two-stage separator that separates grease from wastewater to protect sewerage system and surface water. It comprises of a solids (sludge) chamber that captures food waste sediment followed by a grease chamber that allows the oils, fats and grease (F.O.G) to be separated by gravity and float to the water surface in the grease separation chamber.



Test results

Sample glass no.	130111	130112	130113	130114	130115
Test/minutes	16	17	18	19	20

Results from analysis

Sample label	Variable	Result	Unit	Method used
Sample glass 130111	Total hydrocarbon	24	mg/l	EN 1825-1, 2004
Sample glass 130112	Total hydrocarbon	17	mg/l	EN 1825-1, 2004
Sample glass 130113	Total hydrocarbon	22	mg/l	EN 1825-1, 2004
Sample glass 130114	Total hydrocarbon	23	mg/l	EN 1825-1, 2004
Sample glass 130115	Total hydrocarbon	27	mg/l	EN 1825-1, 2004
Arithmetic mean	Total hydrocarbon	22.6	mg/l	

The **Greaser™** Food Wastewater Grease Separator is designed and constructed in accordance to EN 1825-1:2004 standard. The design is verified and its effectiveness tested by the Danish Technological Institute, a notified body accredited (DANAK) to conduct the EN 1825-1 test for grease separators. Test results showed a residual oil content of less than 25 mg/l oil in the discharge complying to EN 1825-1 standards



For custom design,
visit

www.greaser.app





EN 1825-1

GreaserTM

Engineered Grease Separators

GreaserTM engineered grease separators are also designed inline with the PUB Code of Practise on Sewerage and Sanitary Works 2nd Edition January 2019 Annex E. Special attention shall be given to the inlet connection of Dia 250 mm (up to NS 35 per EN 1825-1) and outlet connection of 150 mm Dia (up to NS10 per EN 1825-1) which shall comply accordingly.

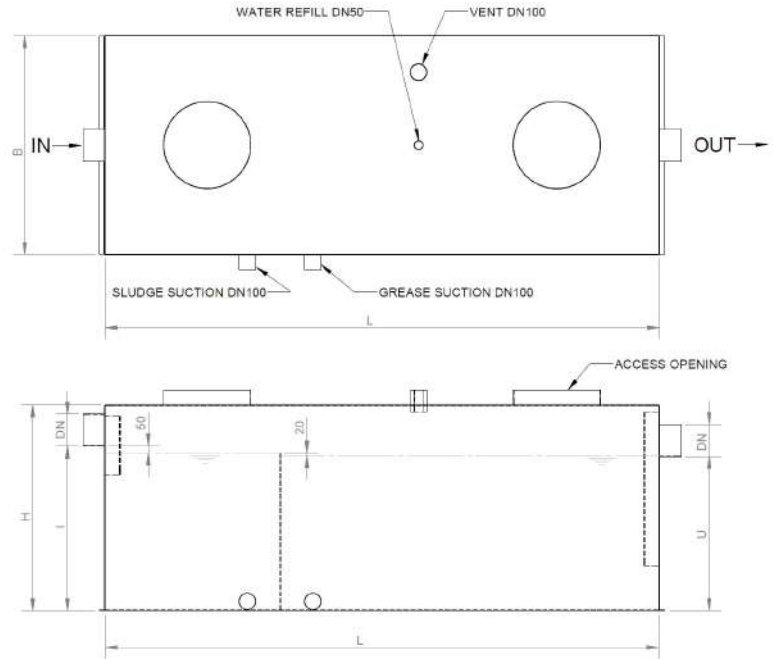

For custom design visit www.greaser.app

Dimensions to conform with PUB C.O.P Jan 2019 connection sizes

NS (l/s)	Inlet (DN)	Outlet (DN)	Length L (mm)	Width B (mm)	Height H (mm)	Inlet Invert I (mm)	Outlet Invert U (mm)	Food Waste Sludge Volume (litres)	Grease Volume (litres)	Total Effective Volume (litres)	Fall (mm)
2	250	150	1150	800	1550	1190	1120	200	80	760	70
4	250	150	1700	800	1550	1190	1120	400	160	1520	70
7	250	150	2400	1000	1550	1190	1120	700	280	2660	70
10	250	150	2900	1200	1550	1190	1120	1000	400	3800	70
15	250	200	3380	1500	1600	1190	1120	1500	600	5700	70
20	250	200	4500	1500	1600	1190	1120	2000	800	7600	70
25	250	250	5280	1600	1600	1190	1120	2500	1000	9500	70
30	250	250	5650	1800	1600	1190	1120	3000	1200	11400	70
35	250	250	6570	1800	1600	1190	1120	3500	1400	13300	70
40	300	300	6750	2000	1600	1190	1120	4000	1600	15200	70

Dimensions for general reference only. Final size subject to individual project requirements



Birkhall Pte Ltd
 19 Keppel Road
 #03-07 Jit Poh Building
 Singapore 089058
www.greaser.com
 Tel: 96809166
 Email: thomas@greaser.com

